

*The part and the whole
Between the lines*

"Certain functions, time, place and culture modify our cities as they modify the forms of their architecture; but such modifications have value when and only when they are in action, as events and as testimony, rendering the city evident to itself..the city realities in itself it's own idea and registers it in stone." Aldo Rossi, The Architecture of the city

The urban conditions are setout to orchestrate multiple processes and interactions so that the inhabitants feel inclusive and spirited post displacement. The edge conditions and the composition of the master-plan advocates an anchoring in the context, strong and irrevocable.

Edges between Formal and Informal - Creation of Vistas

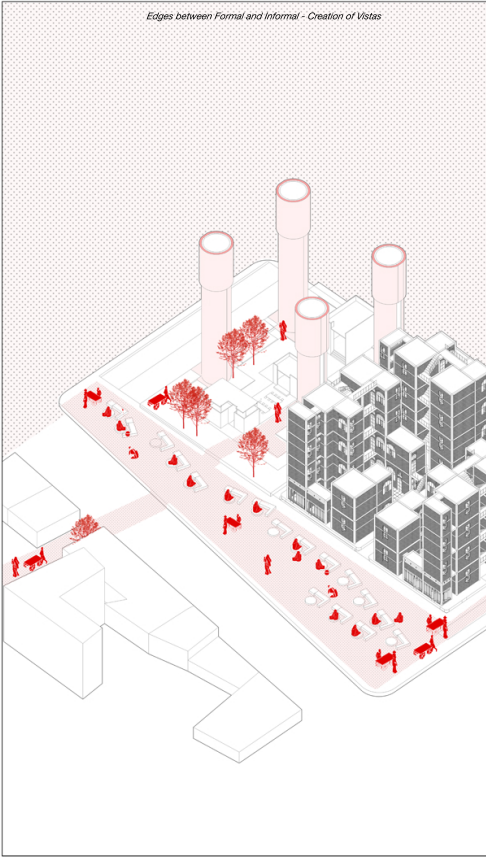

Edges between keys - Volumetric Harmony

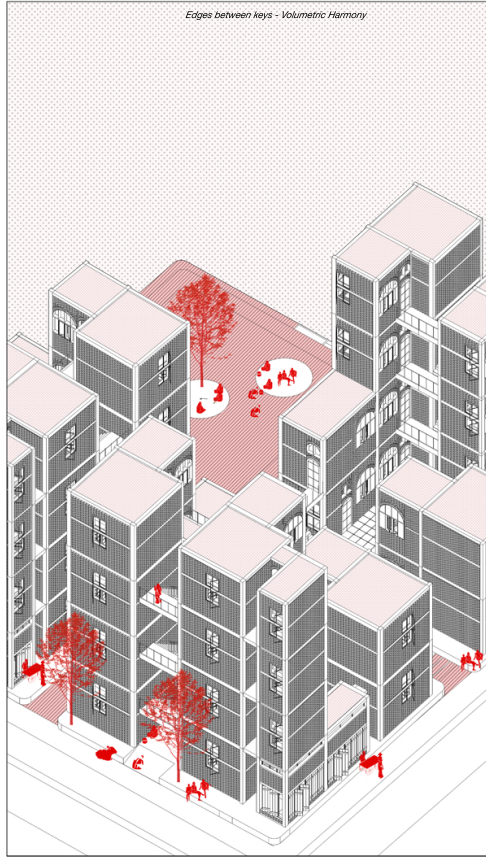

Flexible spaces - open space extension

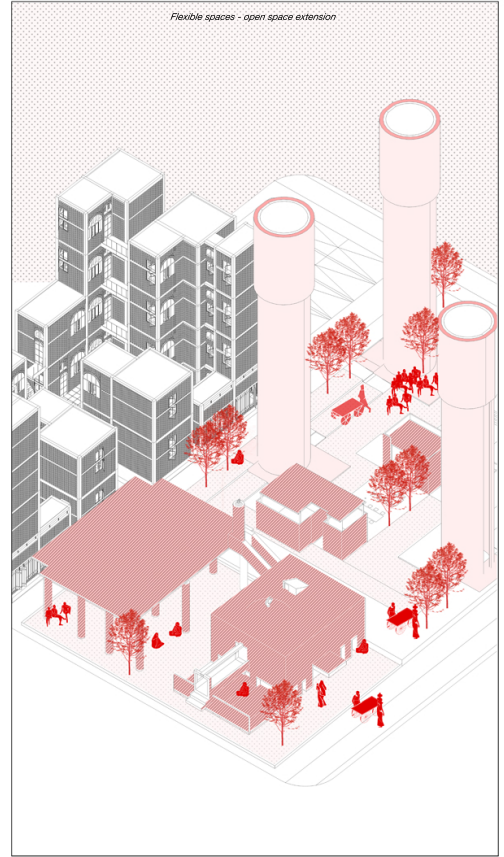

Pedestrian streets



Vehicular streets

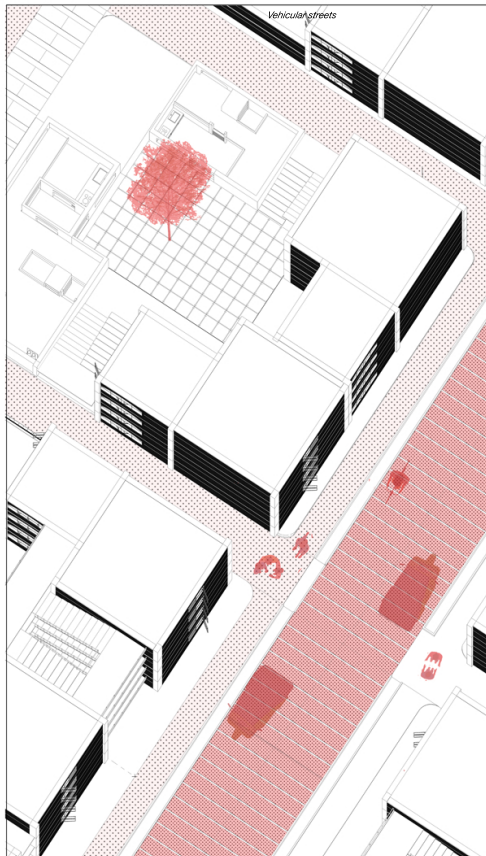

Alleys

